

Enabling Bluetooth on the v5000 Badge

Bluetooth option can be enabled on the Smartbadge Settings menu.

To enable Bluetooth, perform the following:

1. Navigate to the **Settings** screen.
The following default screen is displayed.

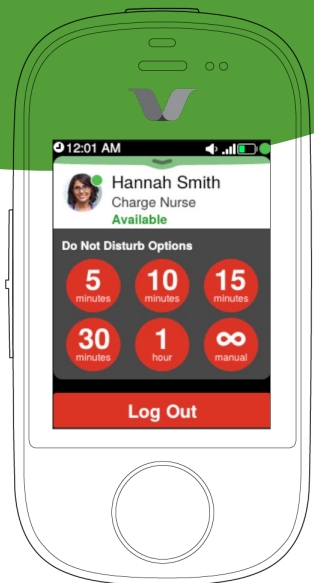

2. Navigate to the Badge Settings.
The following screen is displayed:

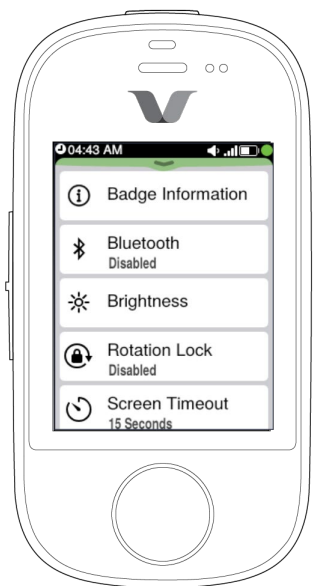

Note: If you do not see the option in the Badge Settings, check if you are logged in to your Smartbadge. If you are logged in to the Smartbadge and do not see the option, contact your system administrator, or enable the option using the Badge Property Editor. For more information, refer to *V5000 Smartbadge Properties Configuration* of the *Vocera Device Configuration Guide*.

3. Tap **Bluetooth**.

The following screen is displayed:

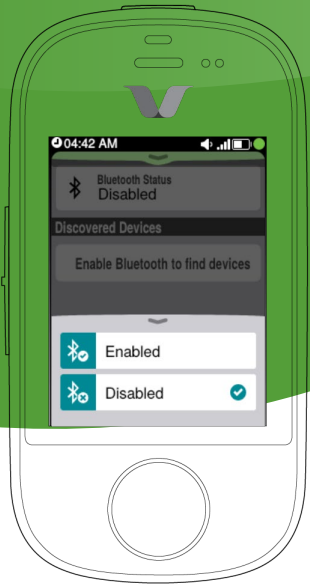

The Bluetooth option is disabled by default.

4. Tap **Enable**.

The following screen is displayed:

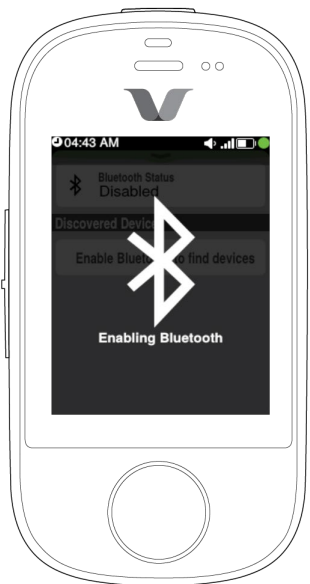

It may take a few seconds for the Bluetooth service to come up. The Bluetooth icon on the top status bar indicates that the Bluetooth is enabled.